

# ALPINE

## Technical Support Tech Tip Document

### Video interlock system sequence

The Alpine system is designed with a sophisticated interlocking system that does not allow you to view video or make any system adjustment while the vehicle is in motion. The system requires the connection of a foot brake (Yellow/Black) and a parking brake (Yellow/Blue) wire. The foot brake (Yellow/Black) wire must be connected to the wire that pulses positive when the foot brake is applied. The parking brake (Yellow/Blue) wire must be connected to the vehicles wire that pulses negative when the parking brake is applied. Once these wires are connected, follow the instructions below to access the advance menu settings.

1. Step and hold the foot brake.
2. Engage the parking brake.
3. Disengage the parking brake.
4. Engage the parking brake.
5. Release the foot brake.

**1. Step and hold the foot brake.**

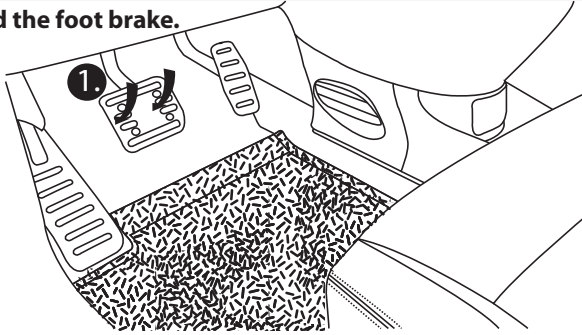

**2. Engage the parking brake.**

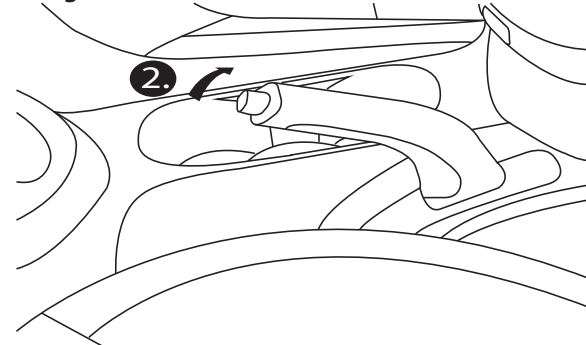

**3. Disengage the parking brake.**

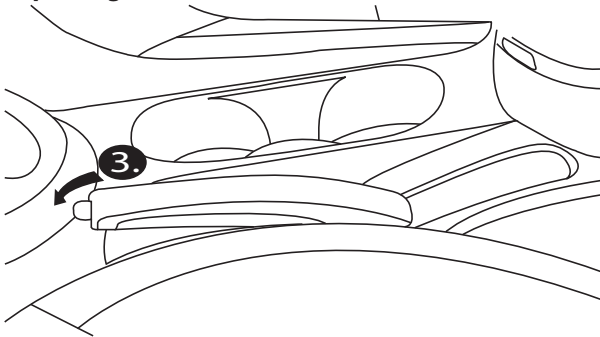

**4. Engage the parking brake.**

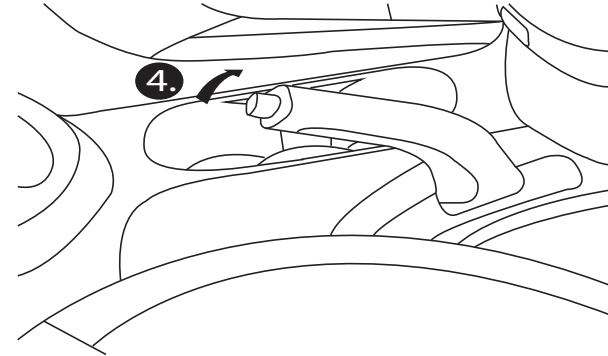

**5. Release the foot brake.**

